

# AS 2293-2005 STANDARD

## EMERGENCY ESCAPE LIGHTING AND EXIT SIGNS FOR BUILDINGS



COMPLIES WITH THE COUNCIL OF STANDARDS AUSTRALIA

AS 2293.1 and 2293.3 standard for emergency escape lighting and exit signs for buildings was designed to provide designers, installers and certifiers the relevant requirements for the provision and installation of emergency escape lighting and exit signs to all designated spaces within a building. This is to ensure an acceptable level of illumination for the safe evacuation of occupants from those spaces in an emergency situation. The AS 2293.1 and 2293.3 standard also provides direction for size, colour and image requirements of emergency exit signage systems.

### Types of Exit Signs

An exit sign is classified as one of the three types as follows:

- As a standard internally illuminated exit sign
- As a low illuminance area exit sign
- As an externally illuminated exit sign

### Exit Sign Size

The minimum allowable size of any pictorial element on an exit sign must be determined by the maximum viewing distance intended under the design as follows:

(a) For viewing distances less than 32 m, see the following table:

| Maximum Viewing Distance<br>(m) | Minimum pictorial element height<br>(mm) |
|---------------------------------|--|
| 16                              | 100                                      |
| 24                              | 150                                      |
| 32                              | 200                                      |

(b) For viewing distances greater than 32 m, see the following equation:

$$\text{Minimum element height} = \frac{\text{Maximum viewing distance}}{160}$$

### Size of Pictorial Elements –

The minimum pictorial element height for any exit sign must be 100 mm, there is no limit on the maximum pictorial element height. It is recommended that the pictorial element height on any exit sign correspond to one of the following discrete sizes:

| Size<br>(mm) |
|--------------|
| 100          |
| 150          |
| 200          |
| 250          |

## Exit Sign Placement

No less than 2 m and no more than 2.7 m above floor level, or immediately above the doorway if the doorway is higher than 2.7 m. Each exit sign must be within the field of view of a person within the applicable viewing distance and looking at the relevant door or along the relevant exit path.

## Exit Sign Appearance

### Colours –

- The green section of an exit sign must be in the shape of a rectangle or square.
- For all sign types, the colour of any additional background must be identical to that of the background within the pictorial element(s).
  - (a) Standard internally illuminated exit signs: The green and white portions of the face of a self illuminated exit sign must lie within the areas defined by the chromaticity coordinates for the colours green and white respectively specified in ISO 3864-1 for ordinary, luminescent, retro reflecting or combined materials and transilluminated safety signs as applicable.
  - (b) Low illuminance area exit signs: The symbols on the face of a low illuminance self illuminated sign must be green. The background must be a colour other than green. A dark colour is recommended.
  - (c) Externally illuminated exit sign: The green and white portions of an externally illuminated exit sign must lie within the areas defined by the chromaticity coordinates for the colours green and white respectively specified in ISO 3864-1 for ordinary, luminescent, retro reflecting or combined materials and transilluminated safety signs as applicable.

### Background –

- When a sign consists of one pictorial element, this element must be located in the center of any additional background.
- When a sign consists of two pictorial elements, these must be immediately adjacent to each other and located in the center of any additional background.
- When a standard internally illuminated or externally illuminated exit sign has only a single pictorial element, the face of the sign must include additional background of an area at least equal to that of the pictorial element.

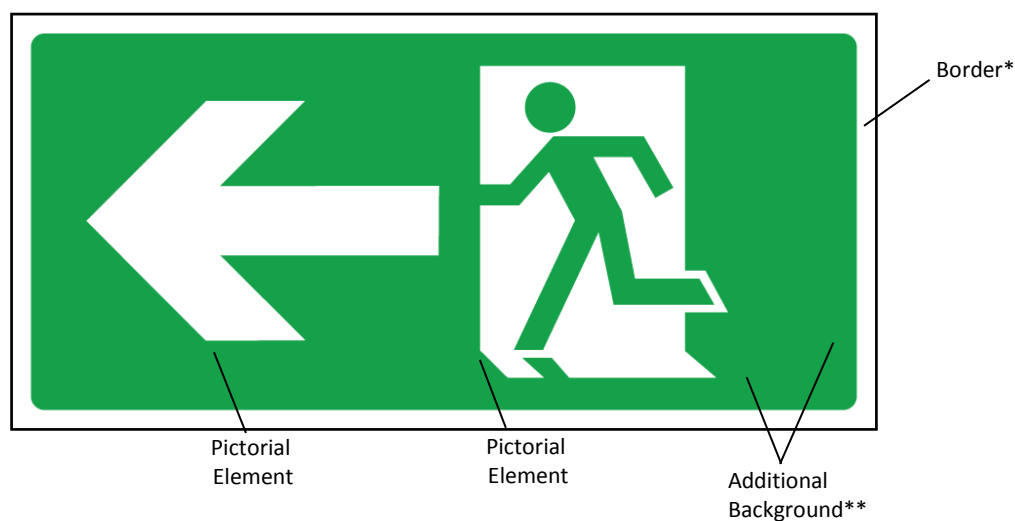

#### LEGEND:

\* = Optional (only allowed on self illuminated exit signs)

\*\* = Optional

--- = Boundary of pictorial element (notional only, does not appear on sign)

### Borders –

- For a standard self illuminated sign and an externally illuminated sign, white transilluminated areas lying outside the areas of green background will be acceptable on condition that any such areas –
  - (a) Form a continuous border around the green background; or
  - (b) Form lines of even thickness either at the sides or above and below the green background areas; or
  - (c) Comprise a total projected area not more than 20% of the combined area of the pictorial elements plus any additional background.

\*Borders are not permitted on low illuminance area exit signs.

### Choice of Image(s) –

The pictorial elements displayed on an exit sign must communicate one of the following messages:

- Straight on from here
- Left from here
- Right from here

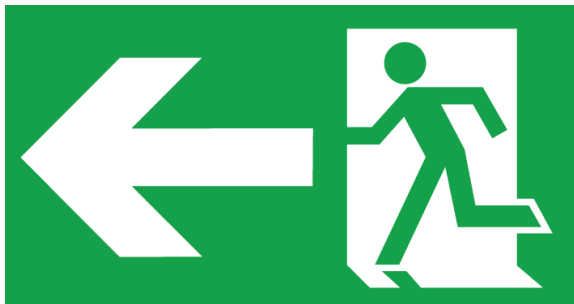

(Left from here)



(Straight on from here)



(Right from here)

### Examples of complying low illuminance exit sign –



(No additional background)



(With additional background)

 = Opaque background (dark colour preferred)

For more information on the AS 2293-2005 Standard, please visit the following source:

Standards Association of Australia – <https://infostore.saiglobal.com/en-us/Standards/AS-2293-1-2005-264239/>